

MACQUARIE POINT MULTIPURPOSE STADIUM

Emergency Management and
Incident Response

REV C - May 2025



MACQUARIE
POINT
DEVELOPMENT CORPORATION



Introduction

Intelligent Risks Pty Limited (IR) are engaged to develop an EMP (Emergency Management Plan) for the stadium and its surroundings. While the stadium is one part of the precinct, it is very much the focal point, and by far the largest element in the redevelopment.

It must be noted the EMP is currently a preliminary draft and will need to be further developed into a final EMP as the stadium planning moves from concept design through to detailed design and construction phases.

The EMP, while addressing the requirements for the stadium will need to be tailored to detailed design, as it progresses, and as the precinct progresses, and it must do so in harmony with its neighbours. These include Port of Hobart (Tasmanian Ports Corporation), the University of Tasmania and other tenants in Evans Street.

This advice has been prepared following initial consultation with the following authorities. Further consultation will need to be undertaken before the EMP is finalised, and will include:

- Tasmanian Stadiums
- Ambulance Tasmania,
- Tasmania Fire Service
- Tasmanian Ports
- Tasmanian Police
- Macquarie Point Development Corporation.

The draft EMP is not included in the EMIR report as it contains sensitive security matters that are to remain confidential.

Glossary of Terms

Glossary of Terms	
Acronym or Term	Definition
EMP	Emergency Management Plan
EMT	Emergency Warning and Intercommunication System
FOP	Field of Play
GA	General Admission
ET	Evacuation Team
IC	Incident Controller
IR	Intelligent Risks
TasPol	Tasmania Police
VCO	Venue Communications Officer
VOC	Venue Operations Centre

DISCLAIMER

Submission is based on the Draft Macquarie Point Stadium EMP v1.0 27 June 2024 (EMP). Subsequent finalisation of the EMP following discussions with emergency responders and other stakeholders during the Detailed Design phase will result in some amendments to processes and procedures which may not be represented in this submission.

Design changes during the Detailed Design phase may also require changes to the EMP.



Stadium Evacuation

Purpose

The purpose of this plan is to prepare and organise the Emergency Response Team (ERT) in conducting a timely, safe, secure, orderly and efficient evacuation of the Stadium. It is designed to cover any incident occurring during the Operational Phase for Event Mode and Non-Event Mode activities. Potential emergencies at the Stadium in either Event or Non-Event mode, which may require partial or full stadium evacuation could include but are not limited to:

- Bomb threat
- Fire
- Explosion
- Power failure, loss of water or sewer
- Crowd violence
- Terrorism

The evacuation plan provides guidance for the management, staff, patrons, hirers and emergency services to minimise threats to people, assets and operations. It covers designated actions that MPS Management and others must take to ensure a safe and secure evacuation in the event of an emergency. This extent of the coverage includes the structures within the Stadium and the perimeter around the Stadium to the border of the Precinct. The plan also covers the emergency evacuations of persons with disabilities in the event of an emergency.

Types of Evacuation

Full Evacuation - With the exception of emergency services and designated ERT/EMT members, all people (including public, event participants, staff and contractors) are required to leave the venue. All occupants will evacuate from the stadium. All occupants will evacuate from the stadium. Once out of the stadium, they will be instructed to disperse away from the stadium towards the CBD and other safe areas, and will be considered to have reached a place of safety. Detailed modelling of the interactions between pedestrians and precinct vehicle movements that inform traffic management responses and actions are to be determined during the development of the Operation Environmental Management Plan (OEMP) that are to be submitted under proposed condition 5.3. Staff and Contractors will be instructed to assemble at the muster points to ensure all are accounted for.

Staged or Partial Evacuation - Except for emergency services and designated EMT members, all people (including public, event participants, staff and contractors) are required to leave parts of the venue affected by the emergency. This may apply to certain types of emergencies. In the event of a fire, a full evacuation may be required.

Shelter-in-Place - People in areas likely to be affected by some types of emergencies (such as bad weather or active armed offender) may be required to remain inside, undercover or move to some other area deemed as a 'safe' location. This may include a venue-wide lock-down in the event of an external threat.

Stadium Evacuation Routes

Events: Ground Level

The Event Level occupants will evacuate via the closest emergency egress stairwells, located in the North-West and South-West of the venue. Event Level occupants will be staff, contractors, players and officials, and they will need to be accounted for at the evacuation assembly areas. Evacuation Team members at Players Tunnel, Dressing Rooms and Field of Play are responsible for advising players, entertainers and officials of evacuation procedures while evacuating via the Western Exits.

The Area Supervisor for the Field of Play and Player areas will guide players and officials to the Western Plaza which will be an interim assembly area. The Incident Controller will coordinate and ensure contract security attend this location. Further instructions will be provided based on the actual situation.

Evacuation Times

In the event of an evacuation due to an emergency, Stadium personnel will be placed at all exits to assist in directing people away from the Stadium and immediate precinct as required.

Relevant, international standards for safety at sports venues are outlined in the Guide to Safety at Sports Grounds – Sixth Edition (Green Guide). Evacuation times for full evacuation of the venue will be in accordance with the Green Guide recommendations (a maximum of eight minutes).

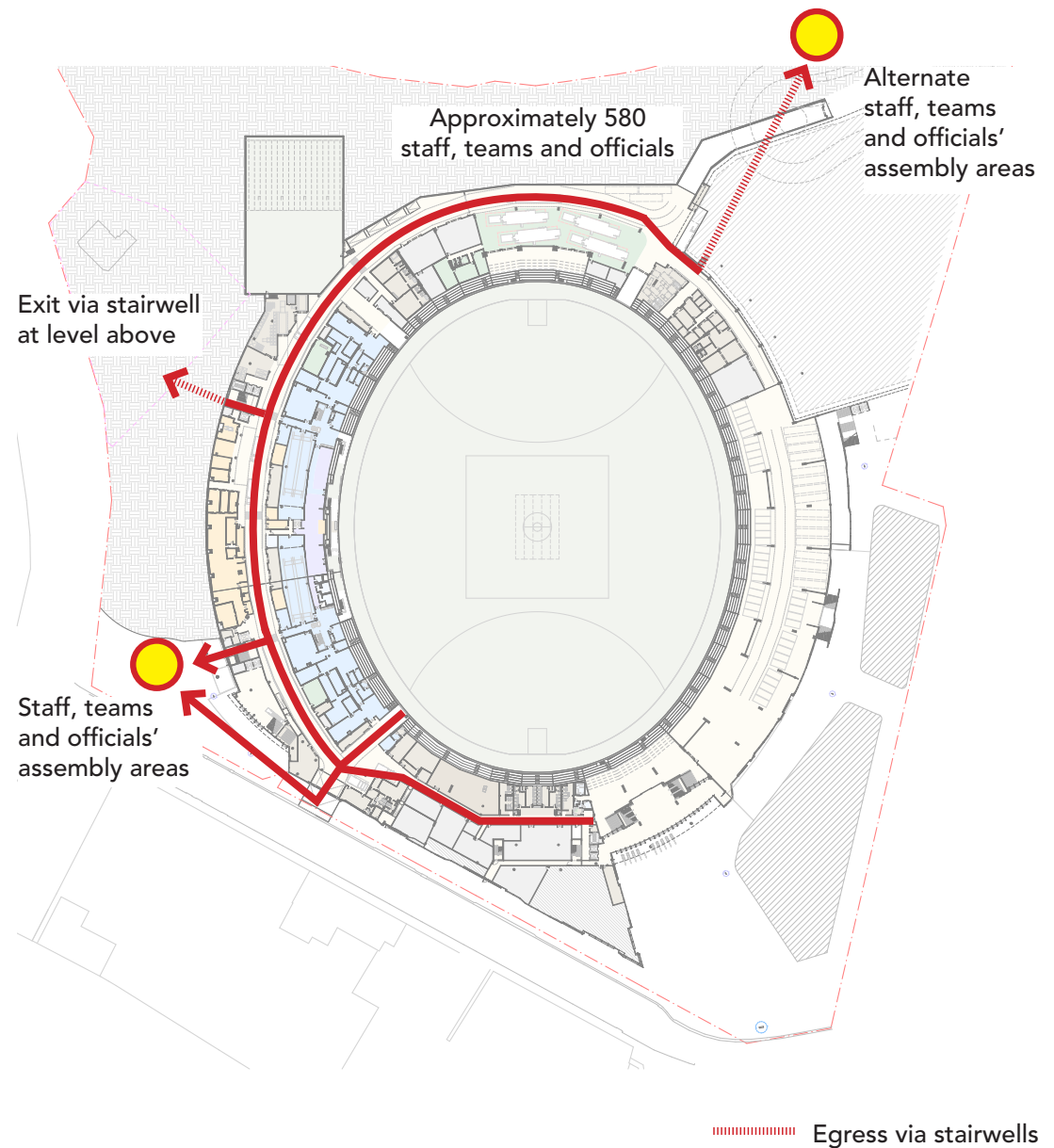

Stadium Evacuation Routes

Concourse: Level 1

If a full stadium evacuation is required, Level 1 Concourse occupants will evacuate via the closest emergency egress stairs or gate located in the North-Western, North-Eastern, Eastern and South-Eastern egresses under the direction of the Evacuation Team. Patrons will leave the precinct as directed and disperse into the CBD or other safe areas. Staff and contractors will assemble at the evacuation assembly points (refer page 4).

- Western Stand: Egress will be via Gates 2 and 3, and the egress stairs
- Southern Stand: Egress will be via Gate 1.
- GA Stand: Egress will be via Gates 1 and 4, as well as egress gates on the east side of the GA concourse.

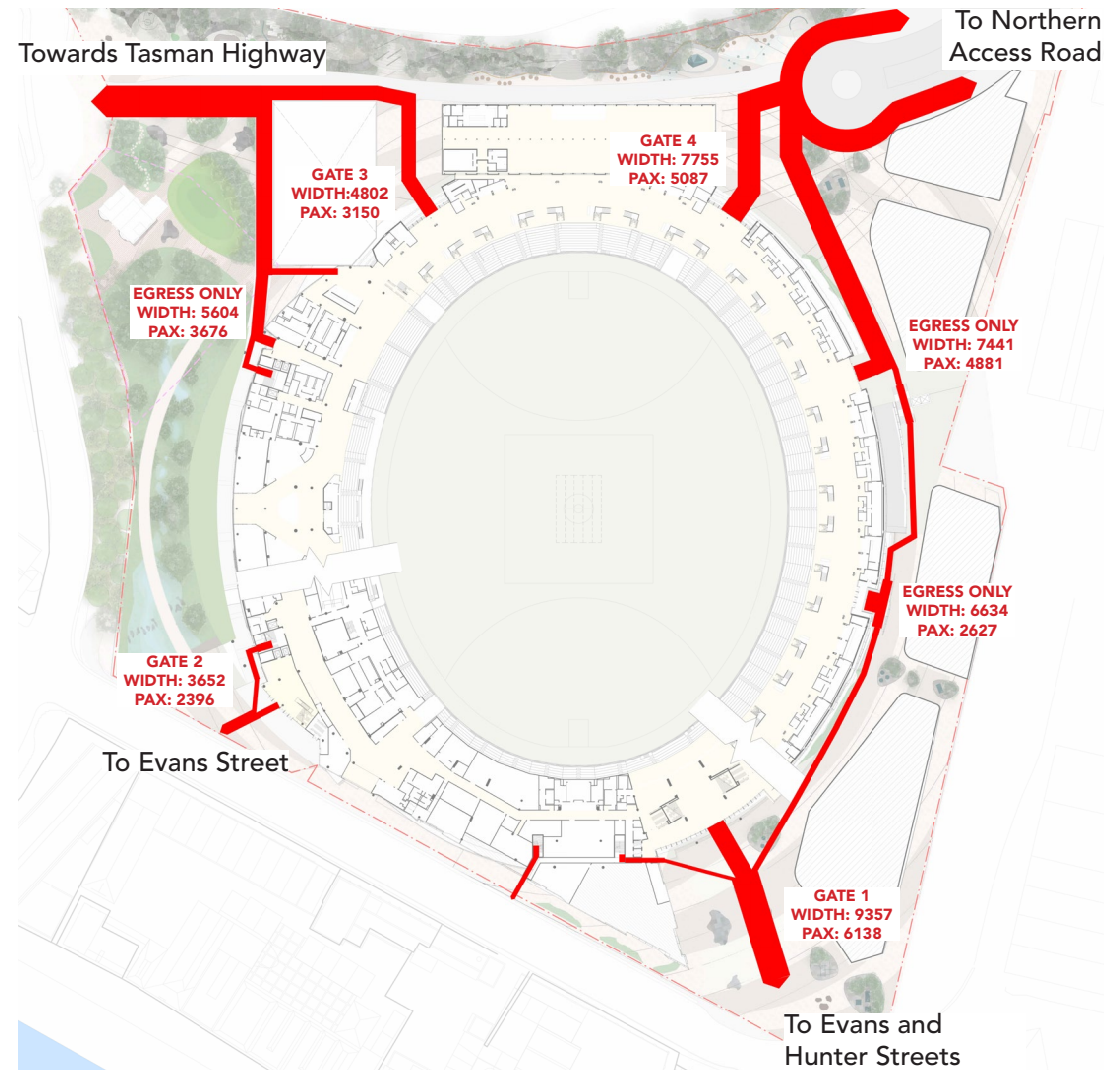

Stadium Evacuation Routes

Functions / Members: Level 2

Occupants on the Premium Members Level egress will be via the North-Western, Western and South-Western stairs, under the direction of the Evacuation Team. Patrons will leave the precinct as directed. Staff and contractors will assemble at the evacuation assembly points (refer page 3).

All staff should understand the methods of assisting mobility-impaired persons during an emergency. Escorts should be trained in how to communicate with people with different types of impairments, and on escorting and lifting methods.

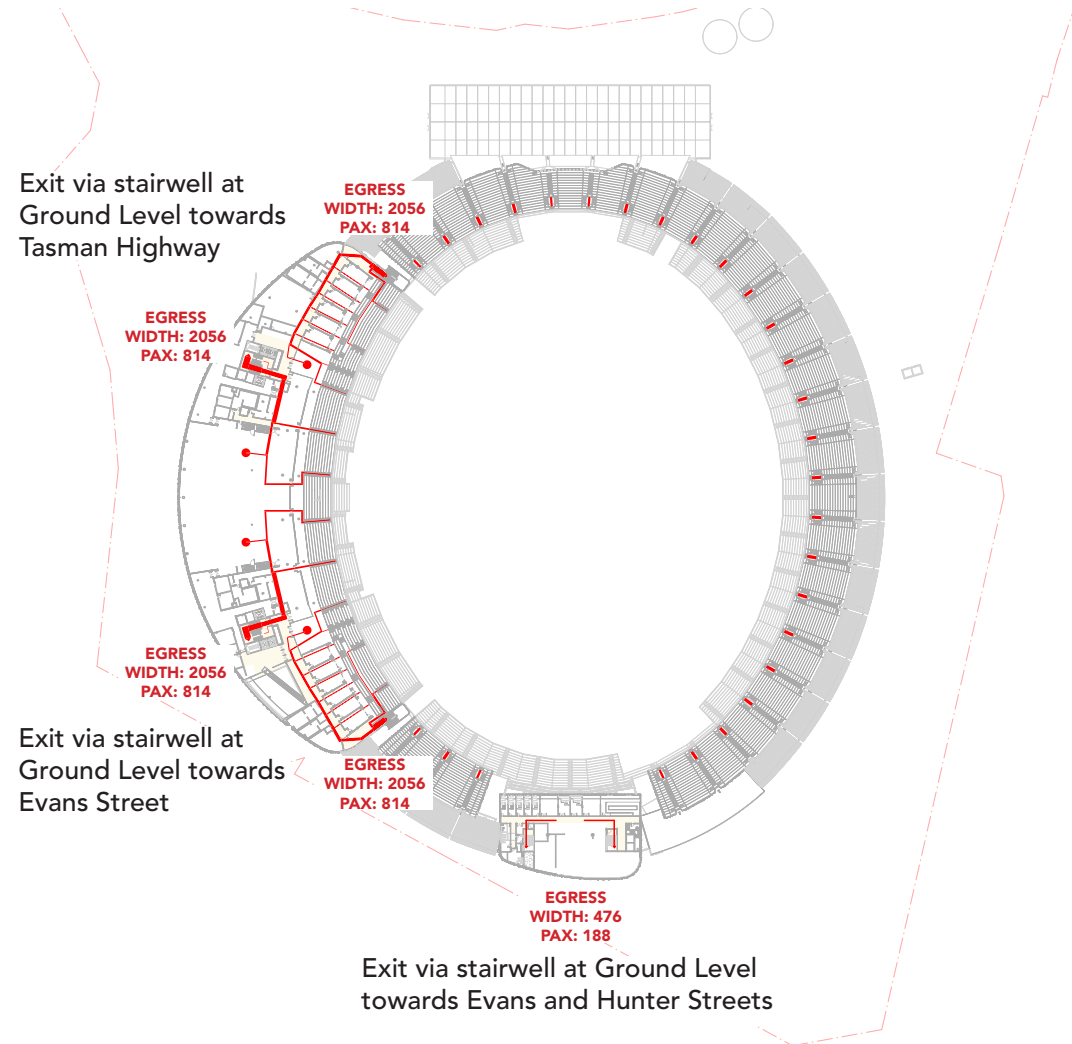

Stadium Evacuation Routes

Media: Level 3

Occupants on the Premium Suite Level egress will be via the North-Western, Western and South-Western stairs, under the direction of the Evacuation Team. Staff, media and contractors will assemble at the evacuation assembly points (refer page 3).

All staff should understand the methods of assisting mobility-impaired persons during an emergency. Escorts should be trained in how to communicate with people with different types of impairments, and on escorting and lifting methods.

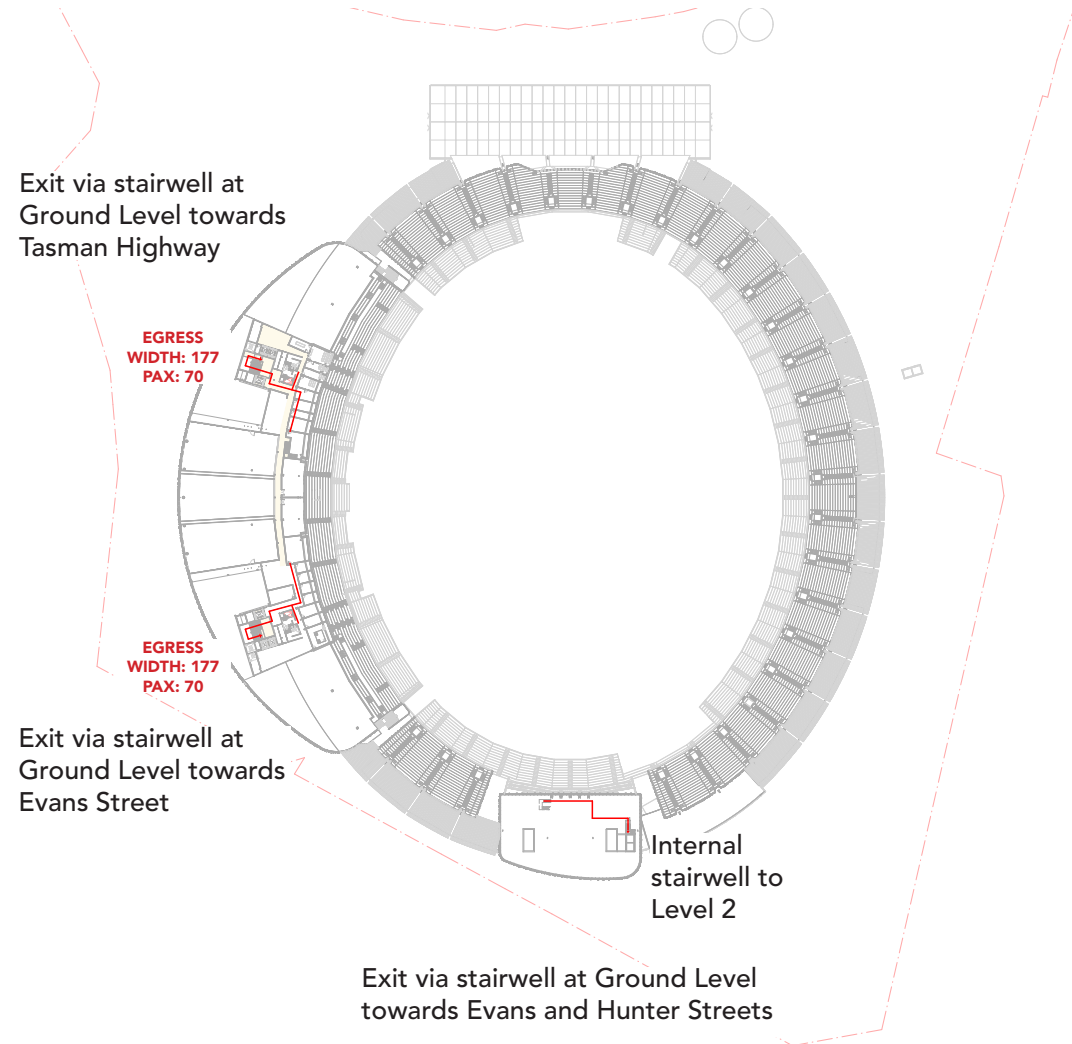

Stadium Evacuation Routes

Concert Mode: Field of Play

During a concert event at the Stadium, patrons will occupy standing area on the field as well as seats within the stands. The evacuation strategy therefore needs to account for high volumes of pedestrians moving outward from the field-of-play. Principally, egress from the field of play will be via the Pitch Access tunnel in the south west and south east. Additional egress for floor patrons in the northern portion of the field will be via the aisles in the lower bowl and out from the Level 1 concourse through every available gateway.

Segments of the lower bowl in front of Gate 1 and directly behind the stage to the north are comprised of retractable seating that will be removed during Concert Mode to facilitate direct egress from the field and out through the main gateways.

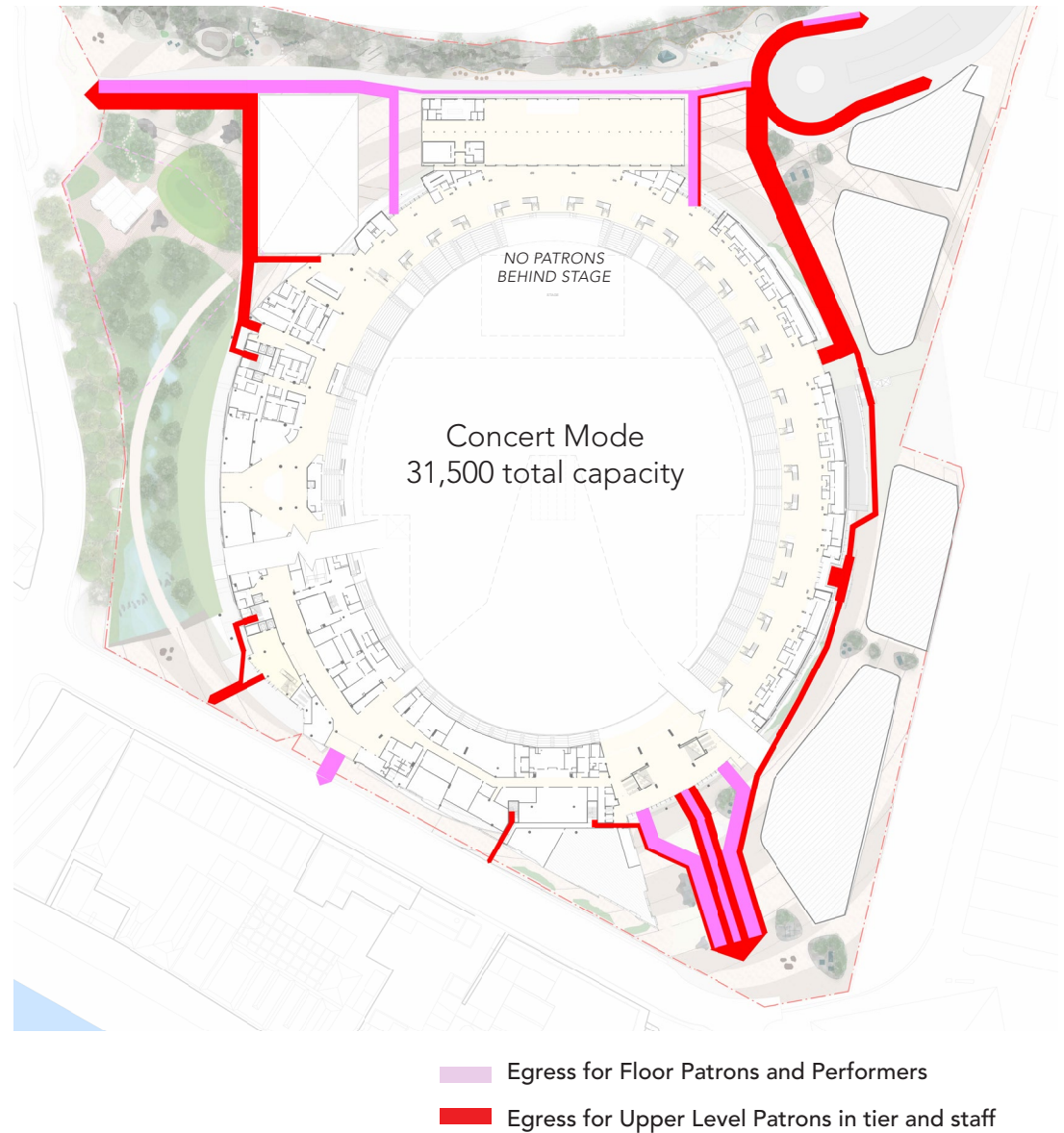

Stadium Evacuation Routes

Concert Mode: Field of Play

Performers and crew will evacuate via the northern egress paths and assemble adjacent to the Outdoor Practice Wickets.

Event staff operating in the back-of-house spaces at Ground Level will evacuate via the fire stairs and assemble in front of Gate 2.

At Levels 2 and 3, evacuation for all staff and patrons in the stands will be via the western fire stairs.

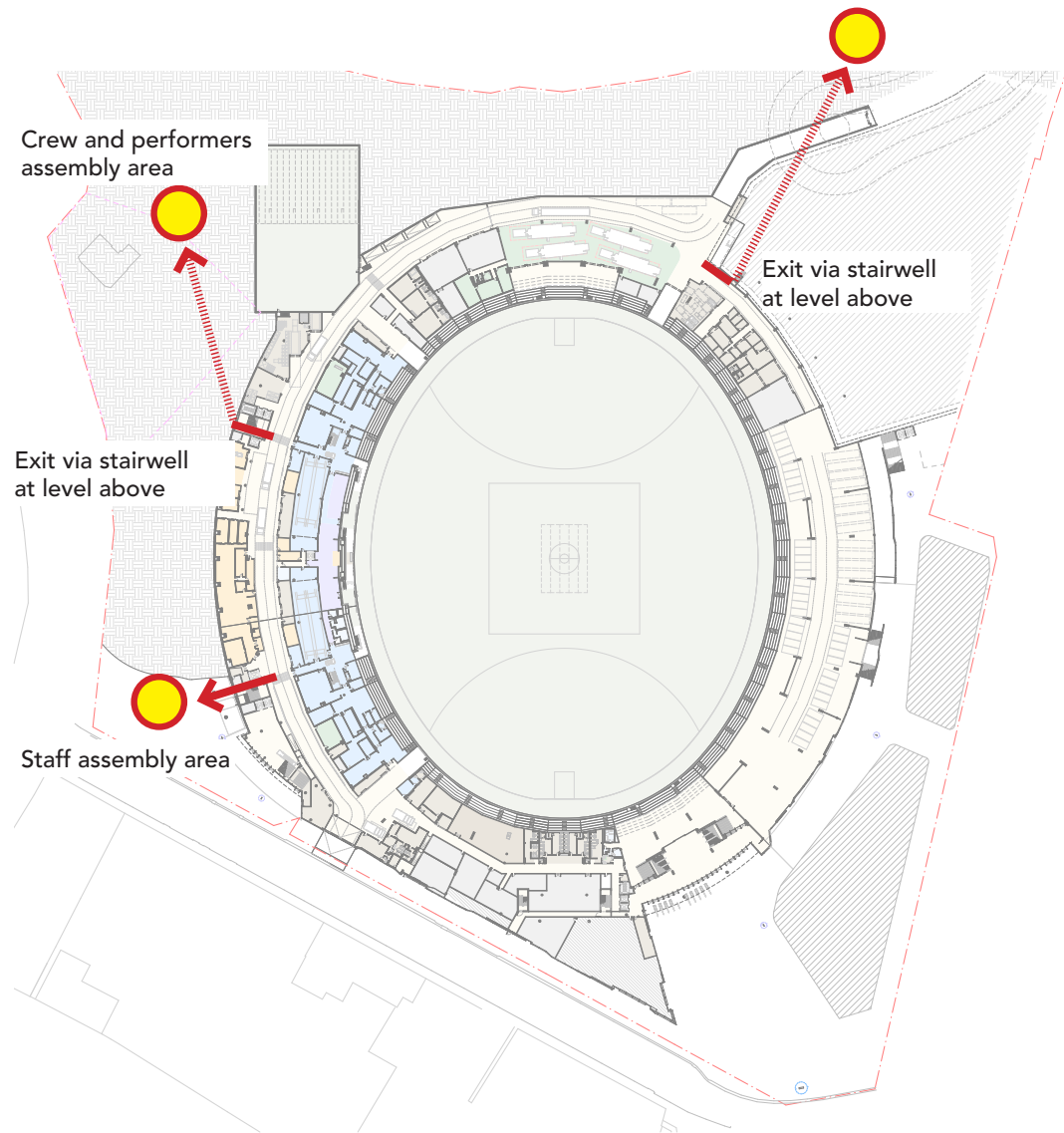

Evacuation Assembly Points

Non-Event Mode

In Non-Event Mode, all occupants are to exit the building via the nearest emergency exit - upon the sounding of the emergency evacuation tone - and assemble at the assembly point below. The occupants will be staff, contractors, visitors and sporting teams in training, and they will need to be accounted for at the evacuation assembly areas.

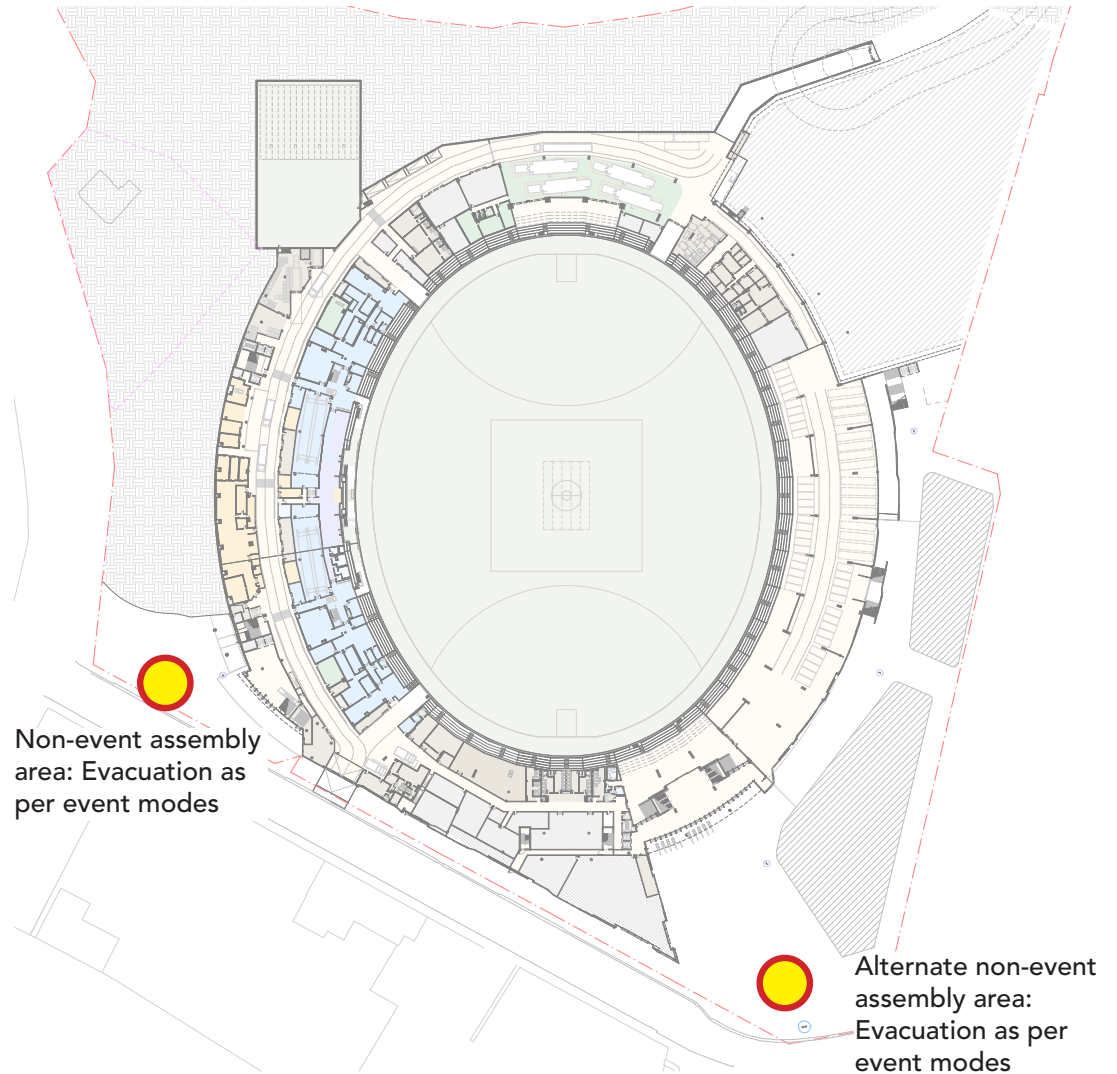

Fire Appliance Access Routes

Fire appliance access and the safe movement of evacuating patrons will be discussed and agreed with Tasmanian Fire Service prior to finalising the Emergency Management Plan during the Detailed Design phase.

However, consistent with the "Guide to Safety at Sports Grounds (Green Guide)", the stadium aims to have conducted a full evacuation within eight minutes. While fire appliances are likely to arrive prior to a full evacuation taking place, the numbers of patrons should be reduced allowing greater movement for appliances and other emergency responders.

Stadium staff and contractors with warden and crowd movement responsibilities will help ensure safe access for fire appliances and other emergency vehicles and for evacuating patrons and staff.

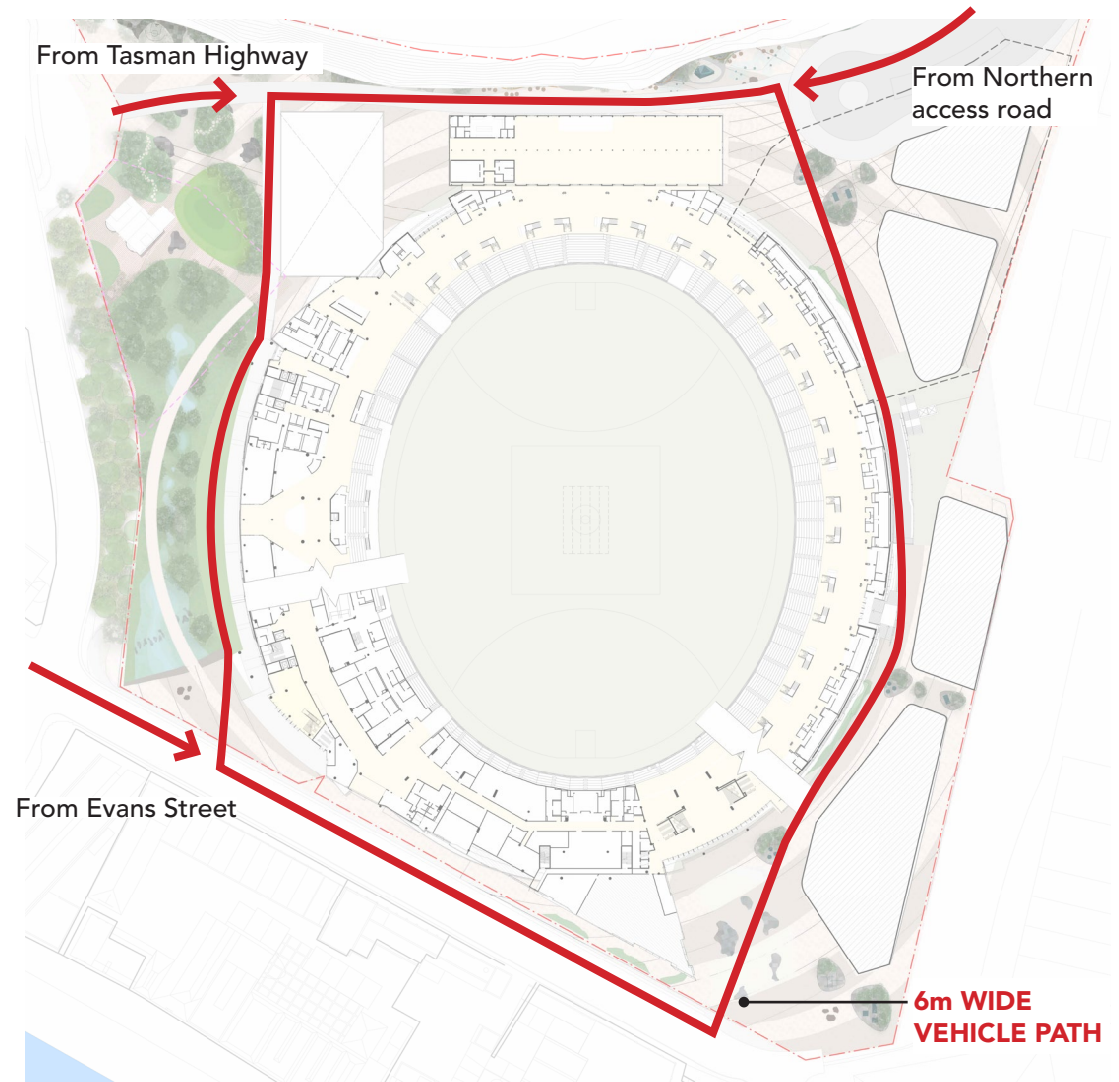

Ambulance Access Routes

Ambulance access will be discussed and agreed with Ambulance Tasmania prior to finalising the Emergency Management Plan during the Detailed Design phase. During events it is expected Ambulance Tasmania will position one vehicle in the ambulance bay.

Should there be a requirement for more than one ambulance to attend an emergency secondary vehicles will arrive via the Northern Access Road.

However, in the event access to the Northern entrance is compromised, access may be via Hunter and Evans Streets. This is to be confirmed with Ambulance Tasmania.

Stadium staff and contractors with warden and crowd movement responsibilities will ensure safe access for ambulances and other emergency vehicles.

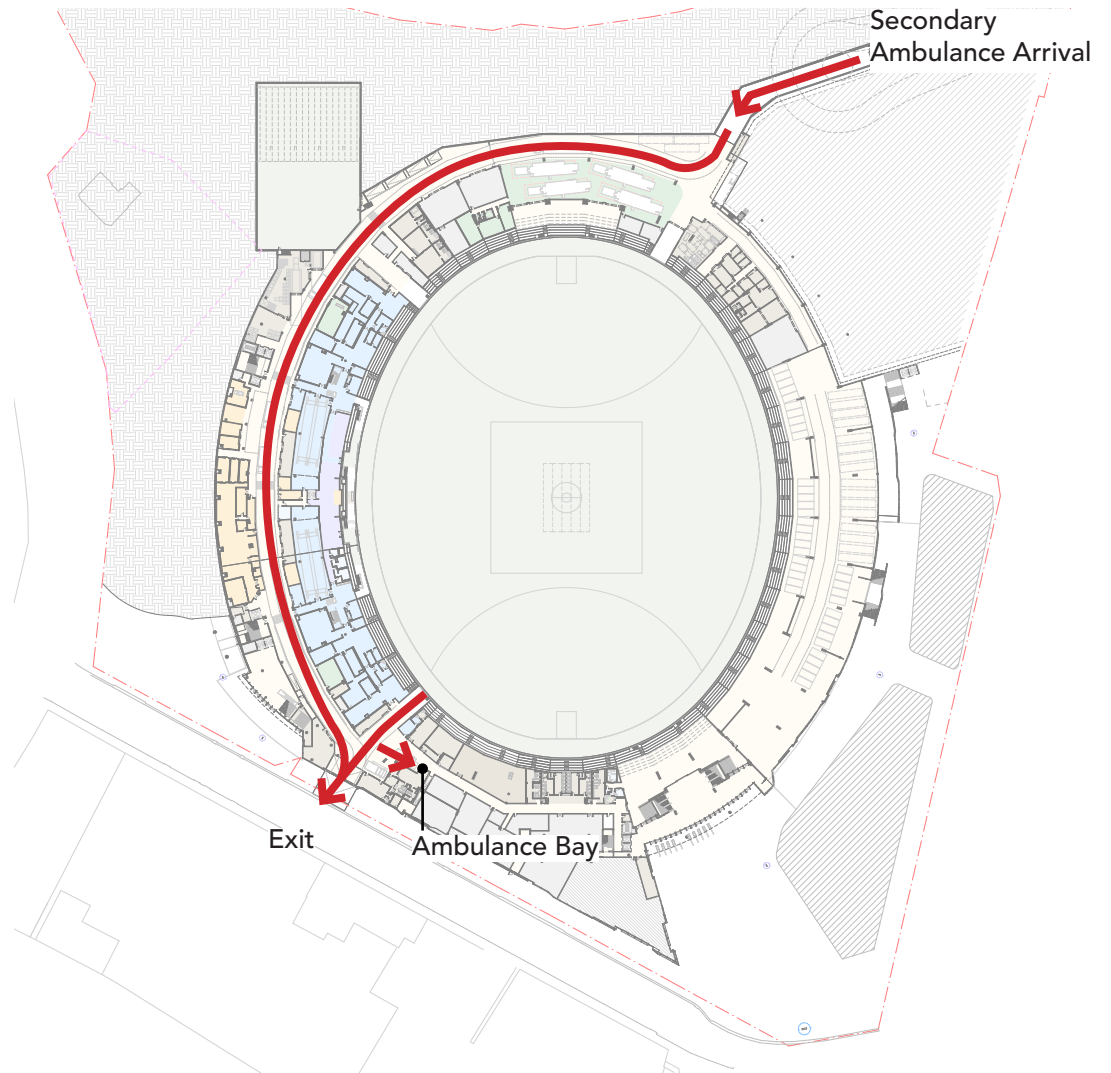

Evacuation Routes

The following diagram demonstrates the cumulative numbers of people and exit widths required at the boundary of the precinct during the largest evacuation mode (concerts).

As described throughout this report, the evacuation strategy during event mode is to evacuate and disperse. Patrons should be directed to leave the immediate area. There are no assembly points for patrons in the event of an evacuation.

Stadium personnel will be placed at all exits to assist in directing people away from the stadium and immediate precinct as required.

Staff and Contractors will assemble at the Assembly Points to ensure all personnel are accounted for.

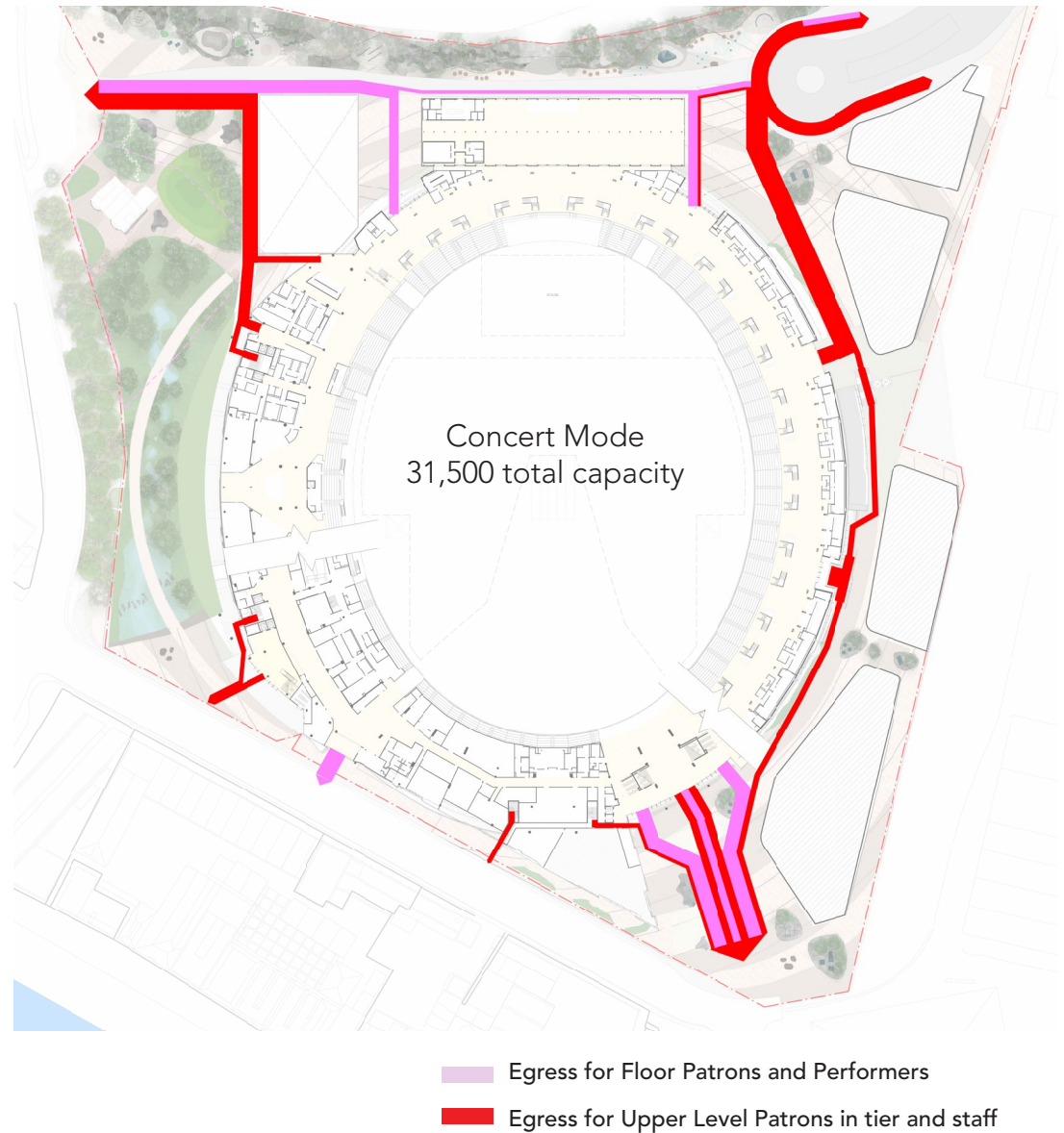

Evacuation Sequence

The fire evacuation strategy allows for all patrons to commence evacuation simultaneously. Moreover, any evacuation due to fire will trigger an automatic evacuation of the entire Arena. This is an immediate all-out evacuation.

For other emergency incidents, the Incident Controller, supported by the Emergency Management Team (EMT), will determine the safest course of action. This may include a partial evacuation, where the emergency is limited to a small and containable location. It may also include a staged evacuation where the immediate risk is to a defined area, but the incident is such that the risk may spread or should necessitate the suspension of the event. In this instance, the Incident Controller may direct that the evacuation be managed in a staged manner, commencing with evacuating the area at immediate threat, followed by the orderly evacuation of the remainder of the Arena.

All evacuations will be proceeded by a communication to wardens advising them to stand-by for emergency actions. All evacuations will be facilitated and directed by event staff to ensure optimal outcome.

Should any exits be deemed unsafe due to blockages or other hazards, the announcements will include advice to patrons and staff to avoid that area. Wardens will be instructed to ensure no-one use that/those exits and to direct patrons and staff to a safe exit. While this may increase the time required to evacuate, clear instructions will help to mitigate this.

Immediate All-out Evacuation

In the event of any of the following, an immediate all-out evacuation is required:

- a confirmed fire;
- a fire alarm that cannot be confirmed as fully contained/ extinguished; or
- a false alarm within 5 minutes.

In the event of an immediate all-out evacuation, the Incident Controller will direct, through Area Wardens,

that an immediate all-out evacuation occur. This will be accompanied by an announcement over the (Emergency Warning and Intercommunication System) EWIS system using Script 1 and accompanying evacuation tones.

Staged or Partial Evacuation

In the event of an evacuation due to an emergency other than fire, a partial or staged evacuation may be directed by the Incident Controller, in consultation with EMT members and police and emergency services.

In this instance the Venue Communications Officer (VCO) will announce a partial evacuation of the location at perceived or actual threat, and subsequent evacuations as required. This will be communicated first to Area Wardens, and then via the EWIS system using Script 1 below.

All staff across the venue must be on standby to assist further evacuation if required.

Unless advised by the Incident Controller that areas of the Stadium have been placed into 'shelter in place' provisions, staff should not interdict persons seeking to leave from another part of the venue during a partial or staged evacuation.

Shelter in Place

If there is an emergency situation external to the venue, or contained within a particular location of the venue, the Incident Controller may suspend an event with the requirement to shelter in place. 'Shelter in place' requires patrons and staff to remain where they are, typically when the threat or potential incident is outside the Stadium and the safest option is for people to shelter inside. An announcement will be read "for safety reasons would all patrons please remain in place. please remain calm and await further instruction."

In the event of a terrorist incident, command will be passed to Tasmania Police (TasPol), and staff should follow all police instructions.

Evacuation Announcements

In the event of non-compliance with requests to return to their seats, the Venue Operations Centre should be immediately informed.

In the event of a terrorist incident, command will be passed to TasPol, and staff should follow all police instructions.

For each evacuation type, should any exit be deemed unsafe, patrons and staff will be directed to alternate and safe exits.

Script 1: Full evacuation

"Ladies and gentlemen can I have your attention please.

Ladies and gentlemen can I have your attention please.

This is an emergency announcement, I repeat, this is an emergency announcement.

Due to a: _____ we are required to evacuate the venue.

Would all patrons, please gather your belongings and make your way calmly to the nearest exit. stadium staff will assist you in the direction of the nearest safe exit.

Once clear of the stadium you are to leave the precinct and disperse into the CBD or other safe area as directed. Stadium staff and contractors not involved in the evacuation are to move to the assembly area for accounting and further instructions.

This is an evacuation of the whole venue.

Please follow instructions of stadium staff outside of the venue. thank you for your cooperation."

Script 2: Staged or partial evacuation

"Ladies and gentlemen can I have your attention please.

Ladies and gentlemen can I have your attention please.

This is an emergency announcement, I repeat, this is an emergency announcement.

Due to: _____ we are required to evacuate part of the venue.

Would all patrons in the [insert location / stand] only, please gather your belongings and make your way calmly to the nearest exit. stadium staff will assist you in the direction of the nearest safe exit.

Could people in all other parts of the venue remain or return to your seats and await further instructions.

Please follow instructions of stadium staff outside of the venue. thank you for your cooperation."

Script 3: Shelter-in-place

"Ladies and gentlemen can I have your attention please.

Ladies and gentlemen can I have your attention please.

This is an emergency announcement, I repeat, this is an emergency announcement.

The event has been suspended due to: _____.
For safety reasons would all patrons please remain in place. please remain calm and await further instruction.